

ELECTRIC FORKLIFT TRUCK SERIES F 16 H

CAPACITY 1.600 Kg
CENTER OF GRAVITY 600mm
VOLTAGE 96V
SUPER-STEERING AXLE
HIGH RESIDUAL CAPACITIES AT
HIGH LIFTING HEIGHTS,
VERY COMPACT
AISLES WIDTH

F

carer
Electric Forklift Trucks



carer
Electric Forklift Trucks

C.A.R.E.R. Srl
Via Copernico 13
48010 Cotignola (RA) Italia
Tel. +39 0545 1938010
Fax +39 0545 908070
info@carerforklift.com
www.carerforklift.com

MAIN FEATURES

- LOAD CAPACITY 1.600 Kg
- LOAD CENTER 600mm
- VOLTAGE 80V
- TYRES C- VLK
- COMPACT DIMENSION
- AC MOTORS
- OIL IMMERSED BRAKES
- SUPER-STEERING AXLE
- TRAVEL SPEED 13,5km/h
- LIFTING SPEED 0,44 m/s
- FORK CARRIAGE TILTABLE
- MULTIFUNCTION DISPLAY EASY INFO (MDE)

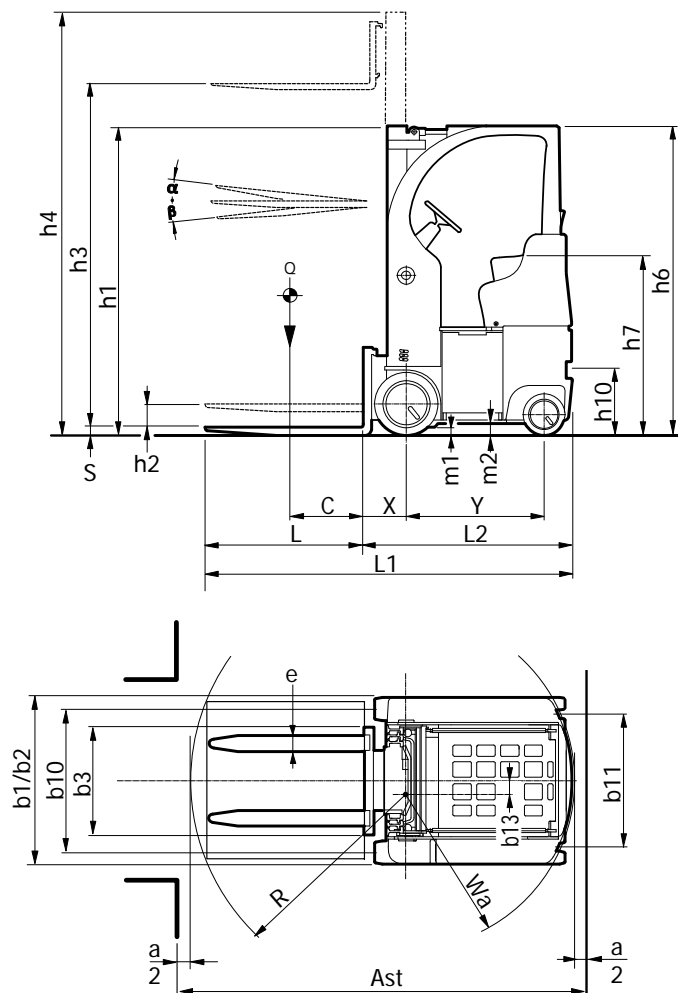

The benefits of choosing Carer

The innovative steering axle, high residual capacities at high lift heights, the very small aisles, the 4 wheel design and compact build and the front driving position, make the F16H the only good alternative for a reach truck where occasional outside use is required.

Specifications

Two electric motors with alternating current, electronics MOSFET with energy recovery, power and torque give a high speed and maneuverability that are unmatched.

Equipped with a high-visibility mast assembly integrated in the frame construction.

Unique in its kind, the F16 H is the ideal truck for those who must execute movements in confined spaces without sacrificing the

driving direction. Equipped with brakes in oil bath, mounted in the gearbox, a system of electronic braking with energy recovery and hydraulic type of "load sensing" system to optimize energy consumption, this truck is able to support long working cycles with high performances.

The F16 H is equipped with two batteries of maximum 80V 460Ah arranged in the frame so as to also optimize any small space. Available with cushion or vulkollan tyres for heights over 6000 mm



CHARACTERISTICS		C.A.R.E.R. Srl	
1,1	Manufacturer		F16H
1,2	Type		battery
1,3	Power Source: Battery, diesel, gas, electric mains		seat
1,4	Operation: manual, pedestrian, stand, seat		
1,5	Load capacity	Q (t)	1,6
1,6	Load center	C (mm)	600
1,8	Load distance	X (mm)	260(1)
1,9	Wheelbase	Y (mm)	977
WEIGHTS			
2,1	Unladen weight (max.battery)	(kg)	4900
2,2	Axle loading laden front/rear (max.battery)	(kg)	5300/1200
2,3	Axle loading unladen front/rear (max.battery)	(kg)	2290/2610
TYRES			
3,1	Tyres: C= cushion, SE= super-elastic, PN= Pneumatic, SEG= dual super-elastic PNG= dual pneumatic, VLK= vulkollan		C-VLK
3,2	Tyre size, front		457x178 (2)
3,3	Tyre size, rear		300/100 (3)
3,5	Wheels: Number front / rear (X = driven)		2X/4
3,6	Track width, front, standard/wide tread	b10 (mm)	1042
3,7	Track width, rear	b11 (mm)	965
4,1	Mast tilt, forward α / back β	α/β (°)	3/5 (4)
4,2	Height of mast lowered	h1 (mm)	2258
4,3	Free lift	h2 (mm)	1490
4,4	Lift height	h3 (mm)	4360 (1)
4,5	Height of mast extended	h4 (mm)	5130
4,7	Height to top of overhead guard	h6 (mm)	2260
4,8	Seat height	h7 (mm)	1270
4,12	Towing coupling height	h10 (mm)	-
4,19	Overall length	L1 (mm)	2675
4,20	Length to face of fork	L2 (mm)	1475
4,21	Overall width, standard / wide tread	b1/b2 (mm)	1220
4,22	Fork dimensions	exsxL (mm)	100x35x1200
4,23	Fork carriage ISO 2328/30, FEM / A, B		2°
4,24	Fork carriage width	b3 (mm)	720
4,31	Ground clearance under mast, laden	m1 (mm)	45
4,32	Ground clearance at center of wheelbase	m2 (mm)	70
4,33	Aisle width with pallets 1000x1200mm wide	Ast (mm)	2810
4,34	Aisle width with pallets 800x1200mm long	Ast (mm)	2930
4,35	Outer turning radius	Wa (mm)	1210
4,36	Inner turning radius, standard/wide tread	b13 (mm)	0
PERFORMANCES			
5,1	Travel speed, with / without load	(km/h)	12,5/13,5
5,2	Lifting speed, with / without load	(m/s)	0,36/0,44
5,3	Lowering speed with / without load	(m/s)	0,54/0,42
5,5	Drawbar pull, with / without load (S2 60 °)	(N)	1500/1750
5,6	Max drawbar pull, with / without load (S2 5 °)	(N)	7000/7200
5,7	Gradeability, with / without load (S2 30 °)	(%)	5/7
5,8	Max gradeability, with / without load (S2 5 °)	(%)	11/15
5,9	Acceleration time, with / without load (10 m)	(s)	4,4/4,2
MOTORS / BATT.			
5,10	Service brake: mech. / Hydraulic / electric		idr/elett
6,1	Drive motor output (S2 60 °)	(kW)	2x4,5
6,2	Lifting motor (S3 20%)	(kW)	12
6,4	Battery voltage	U (V)	80
6,4.1	Battery capacity	K5 (Ah)	460
6,5	Battery weight minimum / maximum	(kg)	1250/1350
OTHER			
8,1	Drive control		mosfet
8,2	Working pressure for attachments	(bar)	160
8,4	Average noise level at operator's ear	(dBA)	-

VDI 2198
 (1) TX mast with side shift
 (2) Standard Tyres. For heights > 8.00 m VLK tyres
 (3) Only tires CHS
 (4) With fixed mast with tilt on fork carriage

The performance data refer to forklift truck in perfect efficiency, with battery weight corresponding to the values given in 6,5